

## Technical specification for vented traction cells

### 1. Application

BAE PzS - batteries are low-maintenance and designed for a high cycle life and a high operational safety.

BAE PzS - batteries are ideal for applications for motive power batteries in electric counterbalance trucks, reach trucks, pallet trucks, stackers, order pickers and tow tractors or in unmanned transport systems with daily charging and discharging mode.

BAE PzS - batteries are combinable with  
 – filling system Aquamatik for water  
 – air circulation set NOVA trans airtec.



### 2. Design

Positive plate: robust tubular design including fleece gauntlet with integrated edge protection  
 Electrolyte: dilute sulphuric acid  
 Pole bushing: 100 % acid and gas tight  
 Poles: with brass inlay and thread M10 female  
 Connectors: bolt-on flexible, fully insulated intercell and terminal connectors

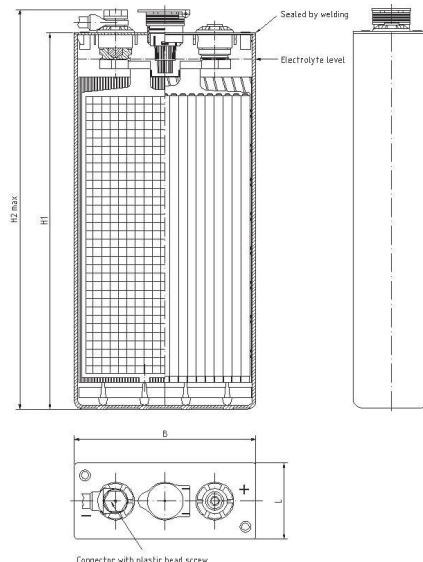

### 3. Operation

Operational temperature: -10 °C to +45 °C  
 Regular discharges: up to 80 %  
 Final charging current: maximal 5 A/100 Ah C<sub>5h</sub>  
 Self discharge: less than 3 % per month  
 No electrolyte spilling from the battery by proper use.

### 4. Charging regime with IUI acc. to DIN 41 773-1

t<sub>1</sub>: initial current: I<sub>1</sub> = 15..20 A per 100 Ah C<sub>5h</sub>  
 t<sub>2</sub>: charging at 2.4 V per cell, current reduction to I<sub>2</sub>  
 t<sub>3</sub>: gas charging with I<sub>2,max.</sub> = 5 A per 100 Ah C<sub>5h</sub>  
 t<sub>1</sub>, t<sub>2</sub> und t<sub>3</sub> are time intervals of charging steps.

(t<sub>1</sub> + t<sub>2</sub>) is set of maximum 10 h for safety reasons,  
 t<sub>3</sub> should be equal to (t<sub>1</sub> + t<sub>2</sub>), but at least 1 h and maximal 4 h.

Further charging regimes acc. DIN 41 773 and DIN 41 774 are possible, e.g. Wa, WOWa and also Wsa.

### 5. Cycle life acc. to DIN EN 60 254-1, IEC 60 254

Using the charging regime acc. to point 4 and observing of the BAE operating instructions, following cycles can be expected:

20 % DOD	6,000 cycles
40 % DOD	3,000 cycles
60 % DOD	2,000 cycles
80 % DOD	1,500 cycles

# Technical specification for BAE *Nova trans PzS*

## 6. Types, capacities, dimensions and weights

Cell type	5 h- capacity <sup>1</sup> (C <sub>5</sub> ) Ah	Length (L) mm	Width (B) mm	Height (H1) mm	Height (H2) mm	Weight <sup>2</sup> kg
2 PzS 120L	120	120	47			8.4
3 PzS 180L	180	180	65			11.8
4 PzS 240L	240	240	83			15.5
5 PzS 300L	300	300	101			19.0
6 PzS 360L	360	360	119	198	340	22.5
7 PzS 420L	420	420	137			26.1
8 PzS 480L	480	480	155			29.8
9 PzS 540L	540	540	173			33.1
10 PzS 600L	600	600	192			36.8
2 PzS 160L	160	160	47			9.8
3 PzS 240L	240	240	65			14.0
4 PzS 320L	320	320	83			18.1
5 PzS 400L	400	400	101			22.6
6 PzS 480L	480	480	119	198	405	26.6
7 PzS 560L	560	560	137			31.1
8 PzS 640L	640	640	155			35.2
9 PzS 720L	720	720	173			39.6
10 PzS 800L	800	800	192			43.9
2 PzS 180L	180	180	47			12.0
3 PzS 270L	270	270	65			16.9
4 PzS 360L	360	360	83			21.6
5 PzS 450L	450	450	101			26.3
6 PzS 540L	540	540	119	198	475	31.1
7 PzS 630L	630	630	137			36.1
8 PzS 720L	720	720	155			40.8
9 PzS 810L	810	810	173			46.0
10 PzS 900L	900	900	192			50.3
2 PzS 230L	230	230	47			14.3
3 PzS 345L	345	345	65			20.3
4 PzS 460L	460	460	83			26.0
5 PzS 575L	575	575	101			31.8
6 PzS 690L	690	690	119	198	570	37.9
7 PzS 805L	805	805	137			43.8
8 PzS 920L	920	920	155			49.8
9 PzS 1035L	1035	1035	173			55.7
10 PzS 1150L	1150	1150	192			61.5
2 PzS 280L	280	280	47			18.2
3 PzS 420L	420	420	65			25.4
4 PzS 560L	560	560	83			32.9
5 PzS 700L	700	700	101			39.9
6 PzS 840L	840	840	119	198	720	47.2
7 PzS 980L	980	980	137			54.8
8 PzS 1120L	1120	1120	155			62.3
9 PzS 1260L	1260	1260	173			68.9
10 PzS 1400L	1400	1400	192			76.7

Cell type	5 h- capacity <sup>1</sup> (C <sub>5</sub> ) Ah	Length (L) mm	Width (B) mm	Height (H1) mm	Height (H2) mm	Weight <sup>2</sup> kg
2 PzS 250HS	250	250	47			14.9
3 PzS 375HS	375	375	65			21.0
4 PzS 500HS	500	500	83			26.5
5 PzS 625HS	625	625	101			32.6
6 PzS 750HS	750	750	119	198	570	38.5
7 PzS 875HS	875	875	137			44.5
8 PzS 1000HS	1000	1000	155			50.6
9 PzS 1125HS	1125	1125	173			56.5
10 PzS 1250HS	1250	1250	192			62.1
2 PzS 310HS	310	310	47			19.5
3 PzS 465HS	465	465	65			26.9
4 PzS 620HS	620	620	83			34.0
5 PzS 775HS	775	775	101			42.1
6 PzS 930HS	930	930	119	198	720	48.3
7 PzS 1085HS	1085	1085	137			56.6
8 PzS 1240HS	1240	1240	155			63.0
9 PzS 1395HS	1395	1395	173			73.0
10 PzS 1550HS	1550	1550	192			80.4

<sup>1</sup> Capacity at 30 °C (86 °F) according to DIN EN 60 254-1

<sup>2</sup> Cell weight filled and charged ± 5 %

All dimensions according to DIN EN 60 254-2 and IEC 60 254-2, series L

Authorized Distributor



**Infinitier Company Ltd.**

Room 601 Bupa Centre, 141 Connaught Road West,  
Hong Kong • Tel: +852 28571793 • Fax: +852 28571079  
<http://www.infinitier.com.hk>



BAE Batterien GmbH  
Wilhelminenhofstraße 69/70  
12459 Berlin · Germany  
P.O. Box 9 – 12442 Berlin · Germany  
Tel. +49 30 53001-661  
Fax +49 30 53001-667  
E-Mail: [info@bae-berlin.de](mailto:info@bae-berlin.de)  
[www.bae-berlin.de](http://www.bae-berlin.de)